

RETROFITTING OR REPLACING A PM3 OR PM4 ON A MODEL C INDOOR ROWER

Performance Monitor Assembly

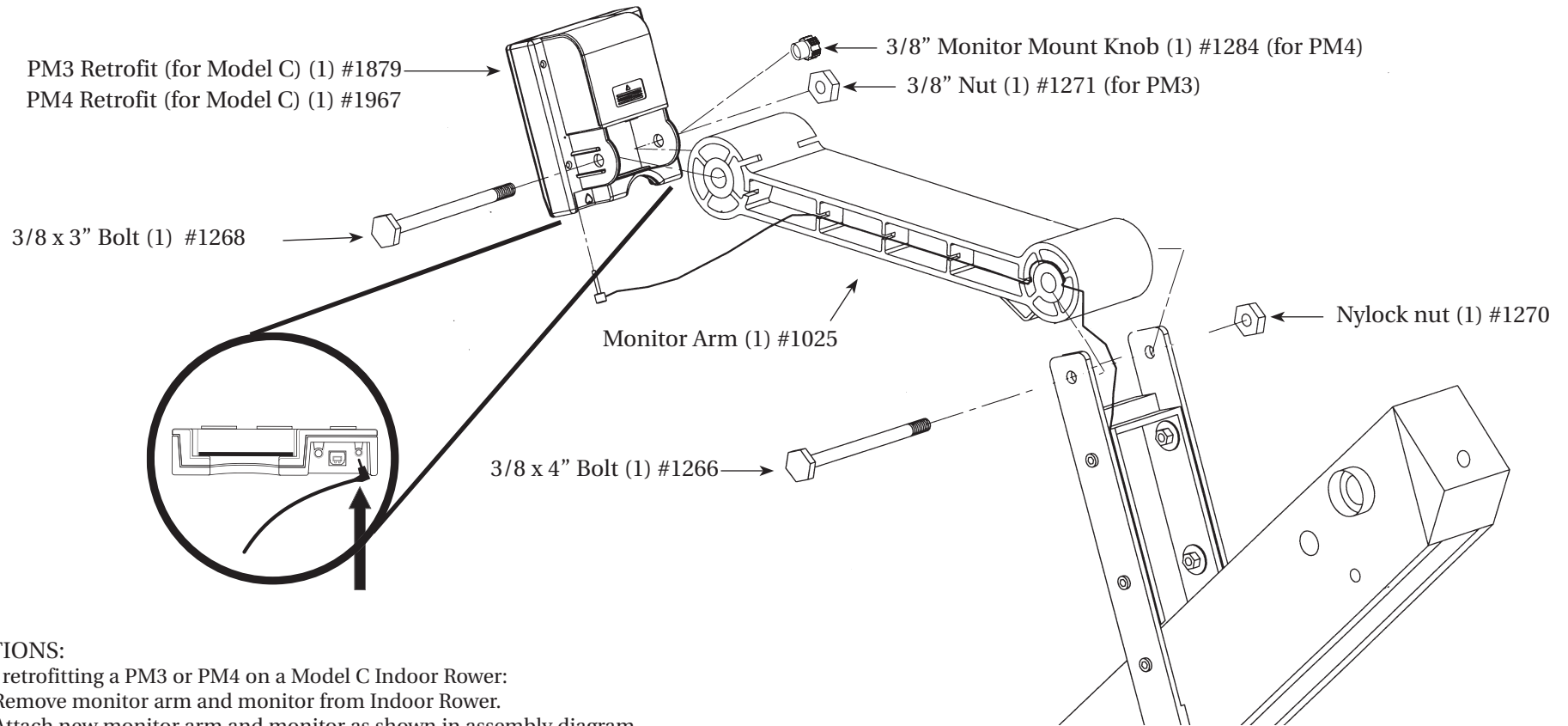

INSTRUCTIONS:

1. If you are retrofitting a PM3 or PM4 on a Model C Indoor Rower:
 - a. Remove monitor arm and monitor from Indoor Rower.
 - b. Attach new monitor arm and monitor as shown in assembly diagram.
 - c. Do not send the old monitor arm or hardware back to Concept2.
2. If you are replacing a PM3 with another PM3 or PM4:
 - a. Unplug monitor wire from monitor and see assembly diagram.

Note: The monitor has been factory-programmed to prevent possible battery drainage during shipping. To restore power, perform ONE of the following procedures:

1. Insert and remove the LogCard into the monitor. A standard credit card will also work.
2. Plug in the pickup cable from your Indoor Rower and pull on the handle.

Troubleshooting:

- For PM3:** If your PM3 fails to activate, use a thick paper clip and press into the small hole on the back left side of the PM3. This will reset and activate your PM3.
- For PM4:** If your PM4 fails to activate, use a pencil or ball point pen and press into the hole on the back right side of the PM4. This will reset and activate your PM4.