

**concept 2** MODEL D2 SCHEMATIC  
INDOOR ROWER

For Model D Indoor Rowers  
made **AFTER** July 31, 2006

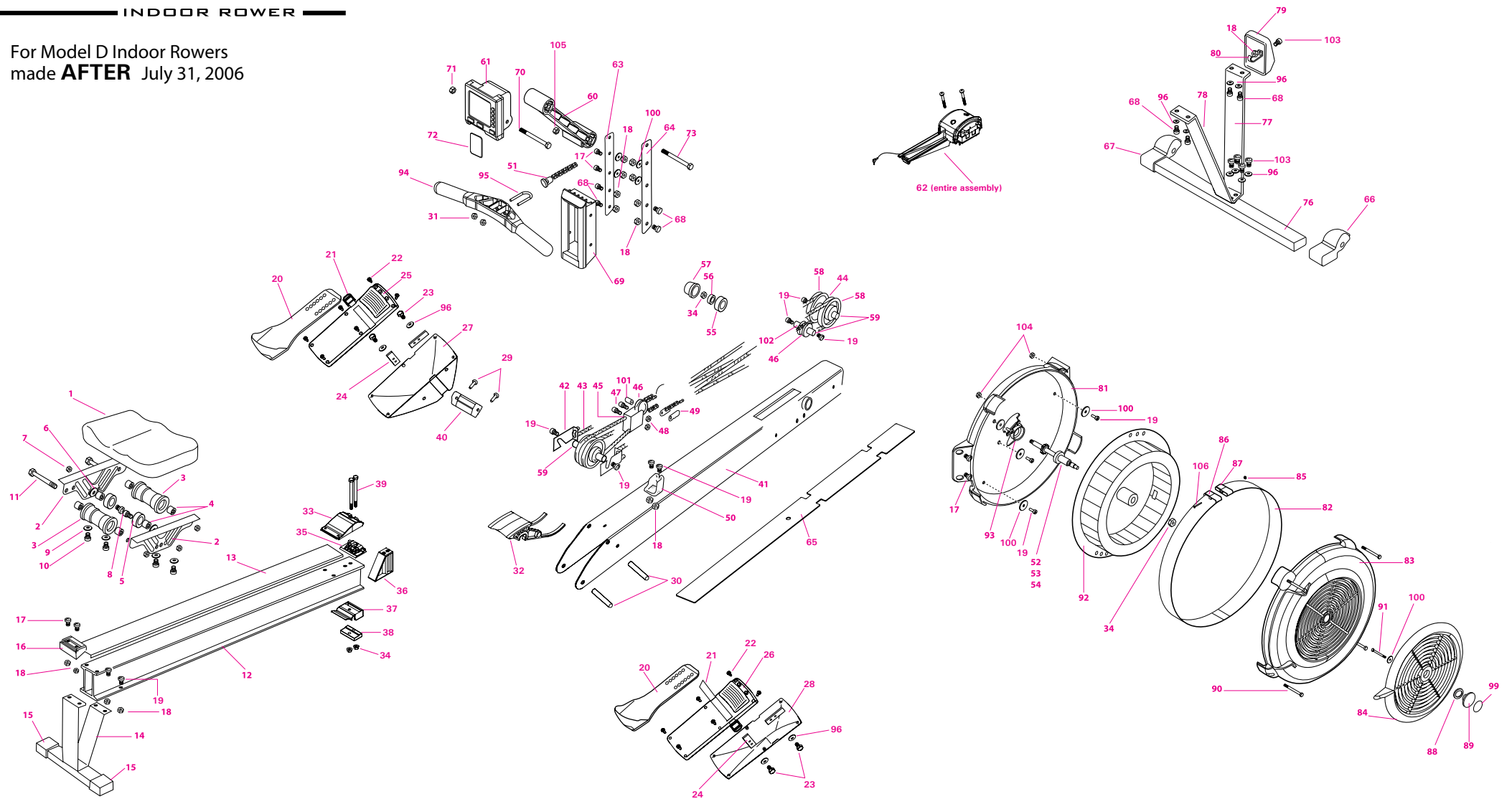

	PN	Description	45	1756	Traveling Pulley	93	1012	17mm Bearing Cup
1	1929	Seat Top w/Screws	46	1024	Chain Idler Pulley	94	1042	Handle
2	1138	Seat Carriage Left	47	1206	Travelling Pulley Screws (x2)	95	244	Handle U-Bolt
	113	Seat Carriage Right	48	1249	Travelling Pulley Nut (x2)	96	1205	Lock Washers (8)
3	1724	Top Roller x2	49	285	Chain Connector Small (see 51)	99	1534	Hubcap label
4	1302	Seat Spacer (see 107/108)	50	1058	Handle Hook w/ screws & nuts	100	1232	Fender Washer
5	1725	Bottom Roller x2	51	1716	Chain with Connector & Swivel	101	1303	Travelling Pulley Spacer
6	125	Seat Roller Washer (see 107/108)	52	1165	Flywheel Axle D/E	102	1305	Chain Idler Pulley Spacer (x2)
7	1209	Seat Roller Nut (see 107/108)	53	1163	14 Tooth Sprocket Quiet D/E	103	1248	3/4" Buttonhead Screw
8	1208	Bottom Seat Roller Axle (see 108)	54	1300	17mm Bearing	104	327	Damper Panel Nut
9	1246	Seat Top Lock Washer (see 1)	55	1013	R8 Bearing Cup	105	1270	Nylock Nut
10	1207	Seat Top Screw (see 1)	56	232	R8 Bearing	106	1274	Perf Outlet Connector Screw
11	1211	Top Seat Roller Axle (see 107)	57	1010	Bearing Cover	107	1727	Top Seat Roller Hardware
12	1954	Monorail Assy D w/Track	58	1011	Shock Cord Pulley	108	1732	Bottom Seat Roller Hardware
13	1762	Track/Tape Assembly w/Rivet	59	1130	Shock Cord Pulley Axle			
14	1951	Rear Leg Model D2 w/Feet	60	1025	Monitor Arm			
15	1044	Rear Foot D2/E	61	1874	PM3 Monitor			
16	1008	Rear Bumper	62	1887	Monitor Sensor/Generator Assembly			
17	1201	3/4" Buttonhead Screw	63	1168	Left Guide Bracket			
18	1213	Nut	64	1169	Right Guide Bracket			
19	1231	1/2" Buttonhead Screw	65	1526	Return Mechanism Cover			
20	1063	Flexfoot Grey D2 & E	66	1059	Right Footcaster			
21	1517	Footstrap with Buckle (one per side)	67	1060	Left Foot caster			
22	1241	Footstretcher Cover Screws x6	68	1253	1/2" Buttonhead Screw			
23	1243	Footstretcher Belly Screw x2	69	1003	Chain Guide			
24	1139	Reinforcing Bracket (two per side)	70	1268	PM3 Monitor Bolt (short)			
25	1055	Left Foot Stretcher Cover	71	1271	Monitor Bolt Nut			
26	1054	Right Foot Stretcher Cover	72	1810	Logcard with Sleeve			
27	1057	Left Belly Footstretcher	73	1224	Monitor Bolt (long)			
28	1056	Right Belly Footstretcher	76	1925	Front Foot w/Casters			
29	1242	Compression Member Screw	77	1173	Leg Front Long			
30	1101	Hanger Shaft Threaded	78	1172	Leg Front Short			
31	1235	1/4 Nylock Nut	79	1009	Arm End Cap			
32	1041	Framelock Mouse	80	1131	Arm End Cap Hook			
33	1038	Plastic Upper Hanger	81	1031	Flywheel Cover Back			
34	1244	Nut	82	1912	Outlet Perf w/Connectors and Screws			
35	1153	Die Cast Upper Hanger	83	1943	Fan Cover Assy			
36	1062	Monorail Bolt Support	84	1061	Damper Lever D2/E			
37	1039	Plastic Lower Hanger	85	1275	Outlet Perf Nut			
38	1154	Die Cast Lower Hanger	86	1035	Perf Connector Screw Side (inc w/82)			
39	1204	Monorail Bolt	87	1036	Perf Connector Nut Side (inc w/82)			
40	1037	Compression Member	88	1278	Wave Washer			
41	1129	Box Frame D2	89	1067	Hub Cap D2 / E			
42	1104	SCAM	90	1276	Flywheel Cover Screw x4			
43	1731	Shock Cord	91	1273	Damper Lever Screw			
44	1310	SC Pulley Spacer	92	1940	Flywheel Assembly (machine made prior to 10/30/06)			
				2940	Flywheel Assembly (machine made 10/30/06 or later)			